



ETERNAL LUXURY
IS FOUND IN
TRUE BEAUTY



Λ M Ā R Λ

AHILYA

— Anderson Road —



PRESTIGIOUS HOMES DESIGNED TO BE PROFUSELY ETERNAL.

At Amara, we have always believed in curating spaces that are alive and thriving. With over a decade of creating expressive works of art in the most prime localities, Amara has pushed the envelope in terms of absolute luxury. Each home is a seamless coherence between tradition and modern living, bearing all the hallmarks of Amara's design of excellence, eternalized.

AMARA
homes



TRUE BEAUTY, IMMORTALIZED IN HOMES OF PERPETUAL PERFECTION.

Introducing Ahilya, where eternal beauty meets timeless lifestyles at the heart of Anderson Road. Each Ahilya home is designed with absolute perfection to immortalize the standard that you stand for. These homes, brimming with artistic soul, are specifically built to capture the heart of a passing reverie, one that you never want to wake up from. It is an experience of unmatched luxury and universal ambience. Welcome to Ahilya. Truly beautiful. Truly eternal.

5 levels | 10 premium apartments | Fully air-conditioned homes

24-hour security with CCTV surveillance | Imported online water heater system for 24/7 hot water

IoT-enabled smart homes | Landscaped terrace pavilion with party deck



BEAUTY IS IN ELEGANCE THAT IS EVERLASTING.

As a beautiful amalgamation of eternal havens that meet at the heart of the city, Ahilya is ensconced in the radiating brilliance of Anderson Road. Being one of the most iconic locations in Chennai it is seamlessly connected to a world of cultural, educational, entertainment and healthcare avenues. As an eternally inspiring location of renown,

it holds importance to all who want to live a well-connected lifestyle with the highest standard in life.

And that's what truly matters when it comes to picking the perfect location.

LIFE AT
AMARA



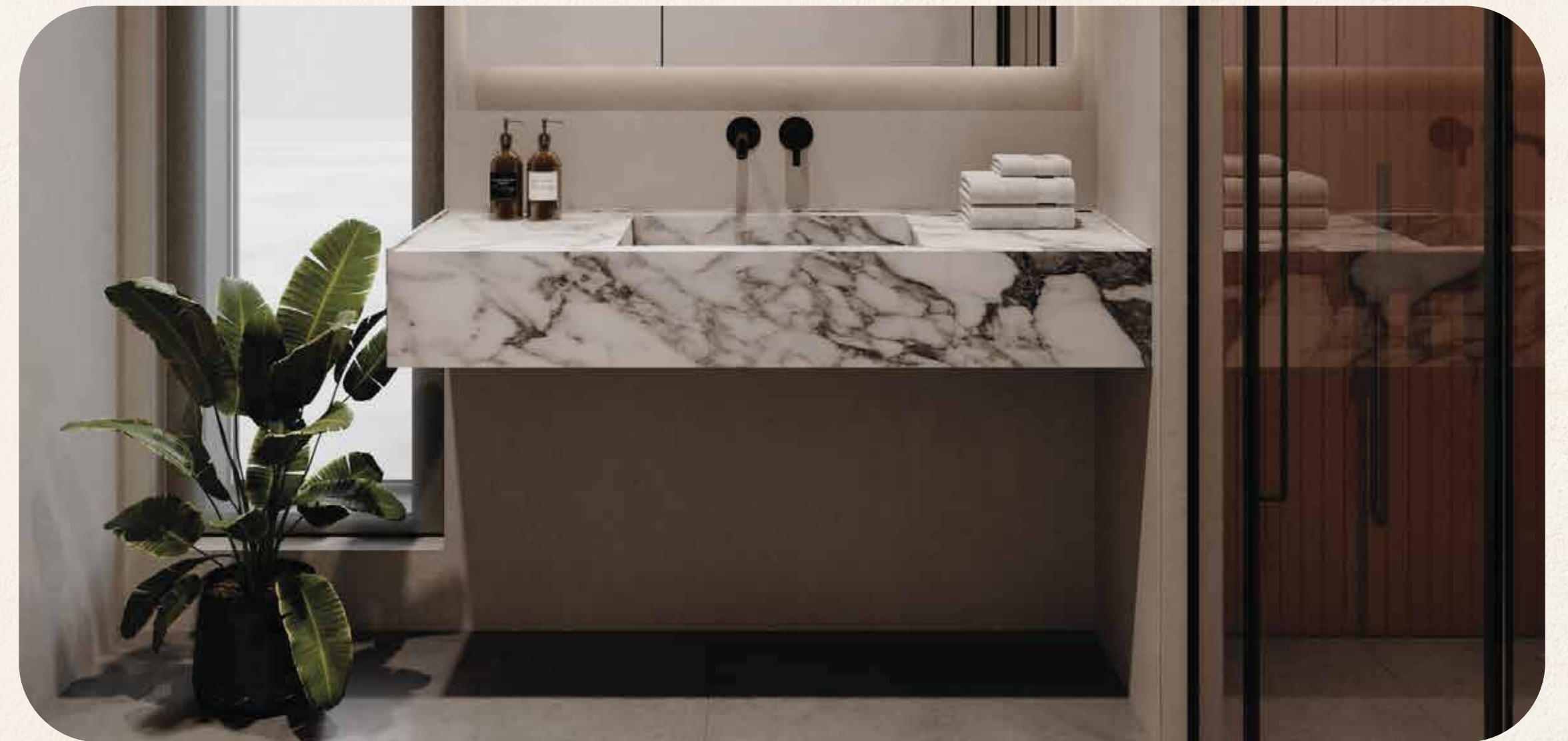



Fully air-conditioned homes.



24/7 CCTV surveillance.



Imported water heating system for 24/7 hot water.

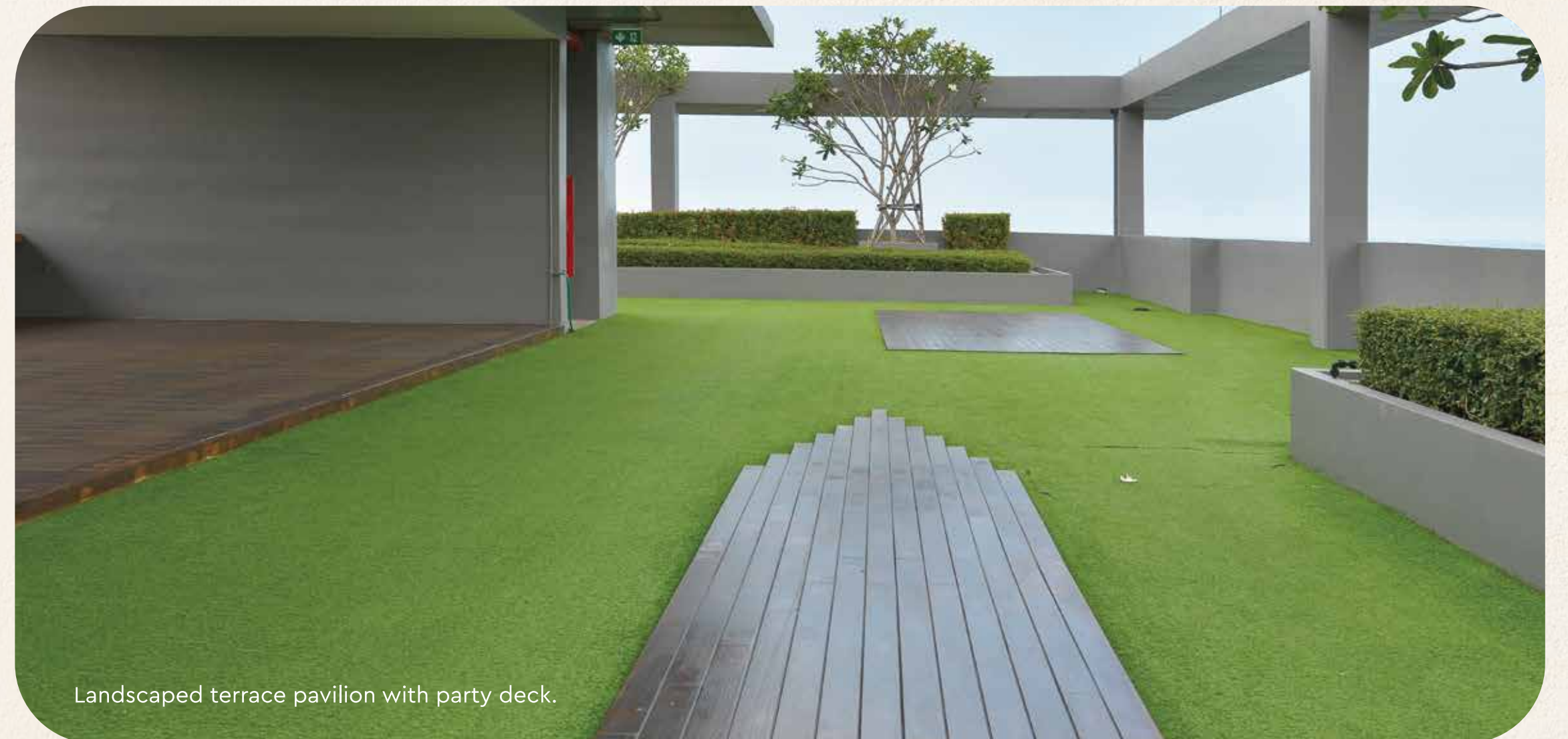

Landscaped terrace pavilion with party deck.

LOCATION MAP



STILT FLOOR PLAN



TYPICAL FLOOR PLANS



1st to 5th Floor





SPECIFICATIONS

STRUCTURE

- R. C. C. framed structure.
- Designed – Seismic Resistant structure – Zone III.
- Conformed – IS code 456 Specification.

WALL

- Solid block work.
- Internal and external – Plastered wall.

FLOORING

- Imported Marble in living and dining rooms.
- Imported Marble flooring in bedrooms.
- Double-charge polished vitrified tiles in kitchen.
- Heavy duty outdoor vitrified tiles in balconies and utilities.

DADOING

- Full height vitrified tiles on toilet wall.
- Anti-skid tiles on toilet and utility floor.

WINDOWS & SITOUT

- Saint-Gobain UPVC wood finish windows.

DOORS

- Main/entrance door – 7'10" Hardwood frame and shutter with veneer paneling on both sides and Yale digital smart lock.
- Bedroom door – 7'10" first-quality engineered door frame and shutter with veneer finish and Yale Mortise lock.
- Toilet and other internal doors – 7'10" first-quality engineered door frame and shutter with laminate finish and Yale Mortise lock.

C. P. FITTINGS & SANITARYWARE

- Grohe/Hansgrohe/Duravit/equivalent fittings.
- WC – Wall mounted with concealed cistern and health faucet.
- Stiebel Eltron Online Geyser in all bathrooms.

ELECTRICAL

- 3-phase supply.
- 100% generator backup.
- Legrand Living Now IoT-enabled switches & sockets with modular plates, MCB & ELCB.
- TV, telephone and data points provided.

AIR-CONDITIONING

- Mitsubishi air-conditioning.

FALSE CEILING & LIGHT FITTINGS

- Saint-Gobain Gypsum false ceiling with architectural light fixtures for all areas.

PAINTING & FINISHES

- Internal wall – 2 coat putty with water-based Royale Luxury Emulsion.
- External wall – Waterproof base coat with Asian Ultima Apex/equivalent.
- Ceiling – 2 coat putty with water-based premium emulsion.

RECREATIONAL FACILITIES

- Fully-equipped gymnasium.
- Furnished lobby entrance.
- Landscaped terrace with party deck and barbecue pit.

COMMON AREAS

- Gas bank.
- Mitsubishi – passenger lift – 1 no.
- Imported Marble on all floor lobby areas and lift wall cladding.
- Granite finish staircases.
- CCTV surveillance.
- Motorized entry/exit gates.
- SS handrails on staircases.
- False ceiling with COD lights in all lobby areas.
- Rainwater harvesting.
- Separate lines for Metro water and groundwater.
- UG Sump and OHT provision.
- Solar-powered common areas.
- 100% generator backup.

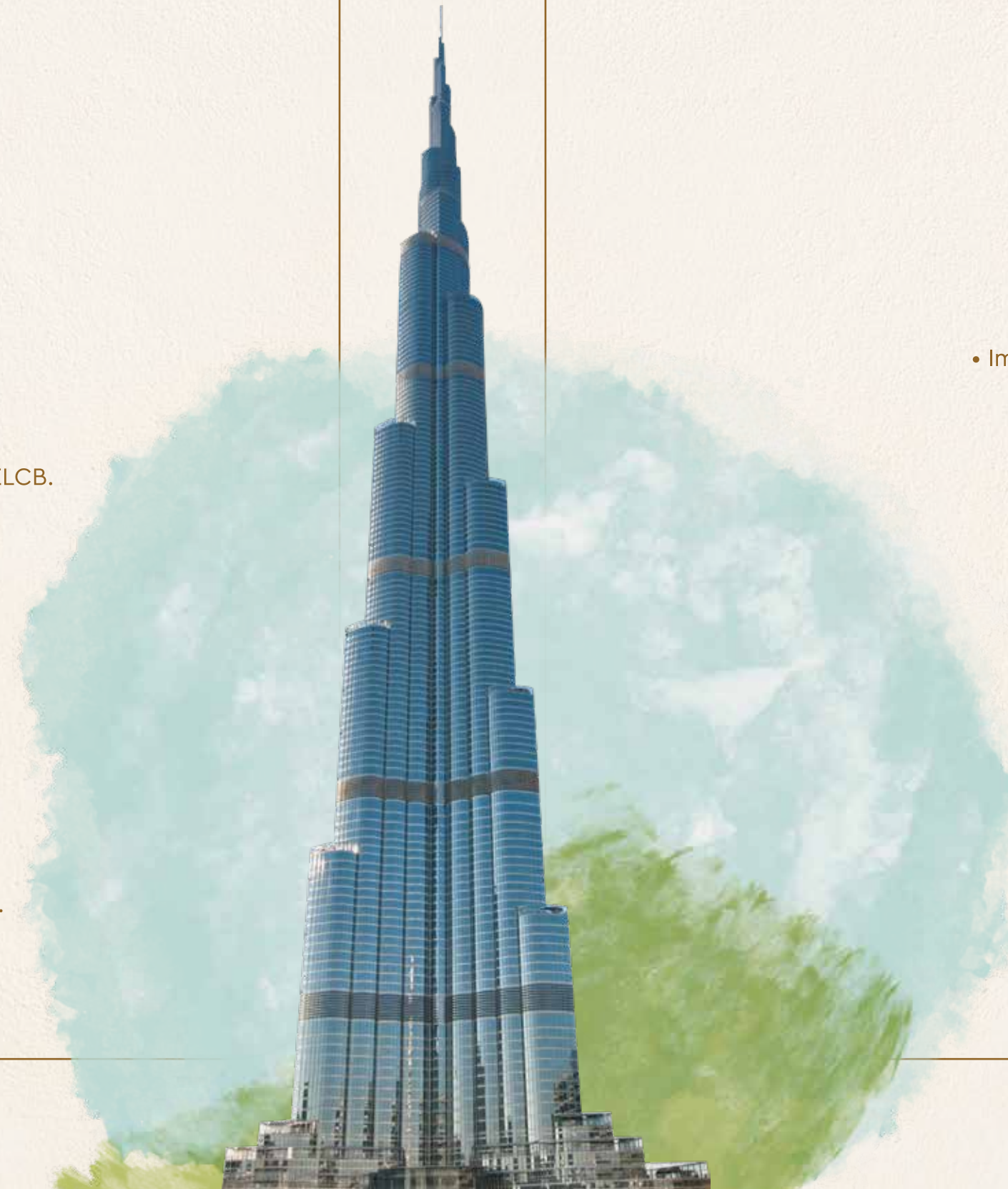

Λ M Ā R Λ
homes

+91 94446 66677 life@amarahomes.in

www.amarahomes.in

RERA NO.: TN/29/BUILDING/0490/2022 | DATED 30.11.2022 | WWW.RERA.TN.GOV.IN